



BMW K 1200 S (2005)
BMW K 1200 R (2005)

Racing & Evolution Exhaust System

Akrapovic Racing & Evolution Exhaust System

for the BMW K 1200 S, BMW K 1200 R (2005)

We have developed Akrapovic Racing and Evolution systems which offer even more muscle for the sporty German K1200S and naked K1200R. And in addition to improved performance, they also deliver a major aesthetic enhancement, as the HEXAGONAL muffler works extremely well with the lines of both motorcycles.

PERFORMANCE

Measurements of the Akrapovic EVOLUTION system on the BMW K 1200 S, R (without muffler insert):

Power & Torque: since the two bikes are closely related, the shape of their power and torque curves are very similar. Only their outputs are different, with the S model being a bit more peppy. Since these are complete systems they are designed to increase power and torque at the top of the range. Thus max. increased power for the S model is 9.3 HP at 10550 rpm and for the R model 7.3 HP at 9960 rpm.

CONFIGURATION

The configuration of the Akrapovic Racing and Evolution systems are identical, differing only in their choice of materials: The tubes for the Racing are made of stainless steel, while the Evolution features titanium tubing. The conical header tubes are attached to the cylindrical collector with a sleeve joint. Another sleeve joint connects the collector with the conical link pipe, and a third sleeve joint is used to attach the muffler to the link pipe. All of the sleeve joints are secured with silicon-shielded springs. The systems also come with fittings for attaching a lambda sensor. The HEXAGONAL muffler is the same for both systems: titanium inlet cap and perforated inner sleeve, and carbon-fiber outlet cap. The outer sleeve is available in either carbon-fiber or titanium. The muffler is attached to the frame with a carbon-fiber clamp.

	PERFORMANCE		
	stock	AKRAPOVIC	max. increased power
max. rear wheel power HP / rpm <small>(measured on SuperFlow Cycle Dyn)</small>	155.8 / 10180 (1200 S) 144.6 / 9850 (1200 R)	163.2 / 10300 (1200 S) 151.8 / 10000 (1200 R)	9.3 / 10550 (1200 S) 7.3 / 9960 (1200 R)

	CONFIGURATION		
	header tubes	collector	link pipe
material	TITANIUM (Evolution) STAINLESS STEEL (Racing)	TITANIUM (Evolution) STAINLESS STEEL (Racing)	TITANIUM (Evolution) STAINLESS STEEL (Racing)
tube shape	CONICAL	CYLINDRICAL	CONICAL

interference crossover tubes	-	lambda sensor	YES
header tube inner sleeves	S.S. CNC MACHINED	header tube flanges	S.S. LASER CUT
header tubes - collector connection	SLEEVE JOINT + SILICON SHIELDED SPRING	collector / header tube - link pipe connection	SLEEVE JOINT + SILICON SHIELDED SPRING
link pipe - muffler connection	SLEEVE JOINT + SILICON SHIELDED SPRING	muffler inlet cap / outlet cap	TITANIUM / CARBON-FIBER
muffler metal interior	TITANIUM	muffler outer sleeve	TITANIUM / CARBON-FIBER
muffler clamp	CARBON-FIBER	muffler bracket	-
muffler insert	EU	-	heat shield
	US	-	catalytic converter

	ADDITIONAL DATA				
	stock	AKRAPOVIC		difference	
		RACING	EVOLUTION	stock - RACING	stock - EVOLUTION
weight comparison (kg)	10.68	4.37	3.85	6.31	6.83
noise measurements (dB / rpm)	stock		AKRAPOVIC		
	95.4 / 5125		99.5 / 5125		
possibility of periodic service without removing A.E.S.	oil		oil filter		
	YES		YES		
legal for street use	NO				

Technical specifications of Akrapovic exhaust systems and related products subject to change without notice.

Product code: 104978 (S-B12R2-RC), 104979 (S-B12R2-RT) racing
104980 (S-B12RFT2TL-RC), 104981 (S-B12RFT2TL-RT) evolution



Akrapovic Racing & Evolution Exhaust System

for the BMW K 1200 S, BMW K 1200 R (2005)



CARBON-FIBER
MUFFLER CLAMP

Product code: 104978 (S-B12R2-RC), 104979 (S-B12R2-RT) racing
104980 (S-B12RFT2TL-RC), 104981 (S-B12RFT2TL-RT) evolution

Akrapovic Racing & Evolution Exhaust System for the BMW K 1200 S (2005)



Akrapovic Exhaust System Technology copyright 2006, all rights reserved

Road
Program

Product code: 104978 (S-B12R2-RC), 104979 (S-B12R2-RT) racing
104980 (S-B12RFT2TL-RC), 104981 (S-B12RFT2TL-RT) evolution

Akrapovic Racing & Evolution Exhaust System for the BMW K 1200 S (2005)



Akrapovic Exhaust System Technology copyright 2006, all rights reserved

Road Program

Product code: 104978 (S-B12R2-RC), 104979 (S-B12R2-RT) racing
104980 (S-B12RFT2TL-RC), 104981 (S-B12RFT2TL-RT) evolution

Akrapovic Racing & Evolution Exhaust System for the BMW K 1200 R (2005)



Akrapovic Exhaust System Technology copyright 2006, all rights reserved

Road Program

Product code: 104978 (S-B12R2-RC), 104979 (S-B12R2-RT) racing
104980 (S-B12RFT2TL-RC), 104981 (S-B12RFT2TL-RT) evolution

Akrapovic Racing & Evolution Exhaust System for the BMW K 1200 R (2005)



Akrapovic Exhaust System Technology copyright 2006, all rights reserved

Road
Program

Product code: 104978 (S-B12R2-RC), 104979 (S-B12R2-RT) racing
104980 (S-B12RFT2TL-RC), 104981 (S-B12RFT2TL-RT) evolution



Akrapovic Racing Exhaust System

for the BMW K 1200 S, BMW K 1200 R (2005)

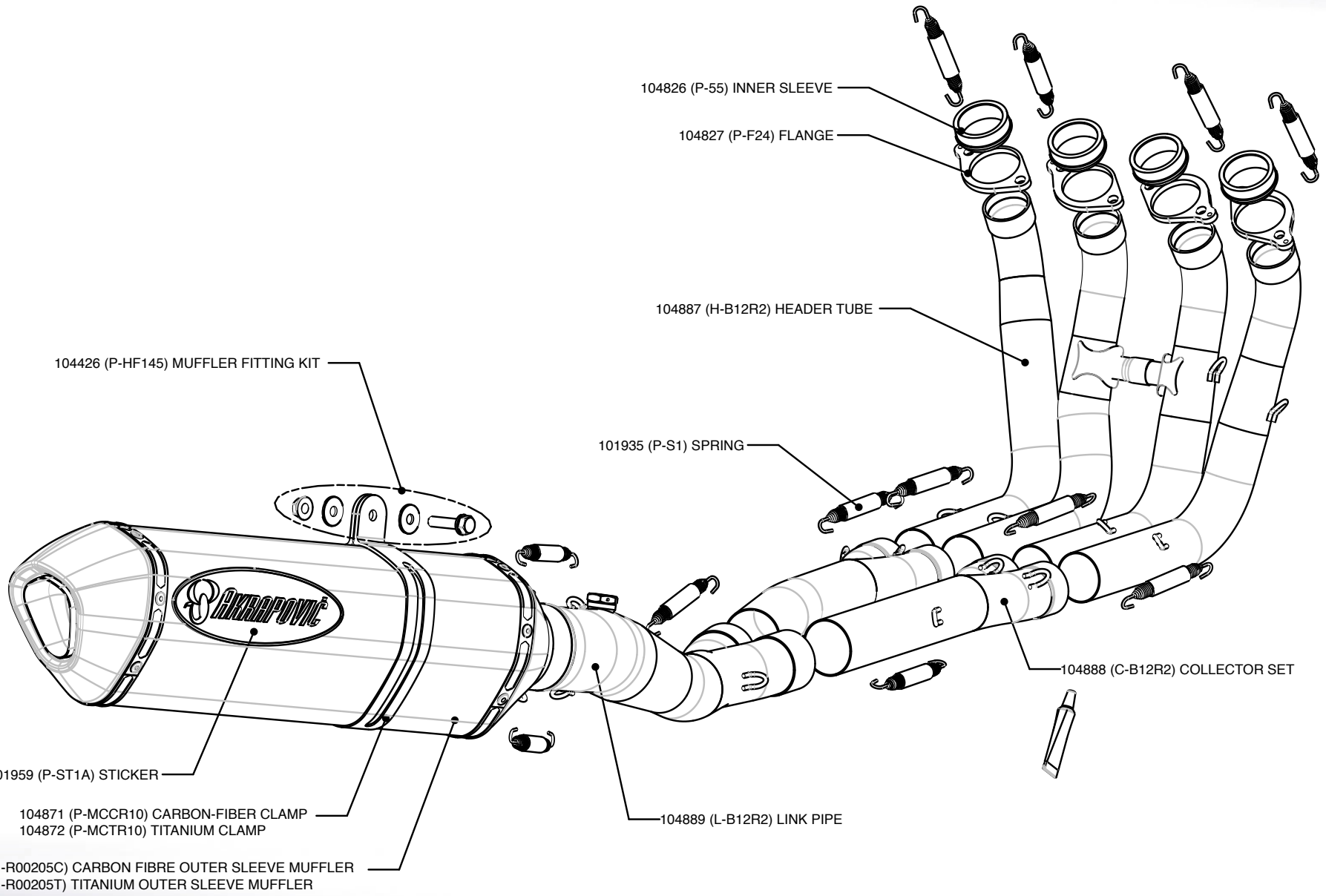

Road
Program

Product code: 104978 (S-B12R2-RC), 104979 (S-B12R2-RT) racing



Akrapovic Exhaust System Technology copyright 2006, all rights reserved

Akrapovic Evolution Exhaust System

for the BMW K 1200 S, BMW K 1200 R (2005)

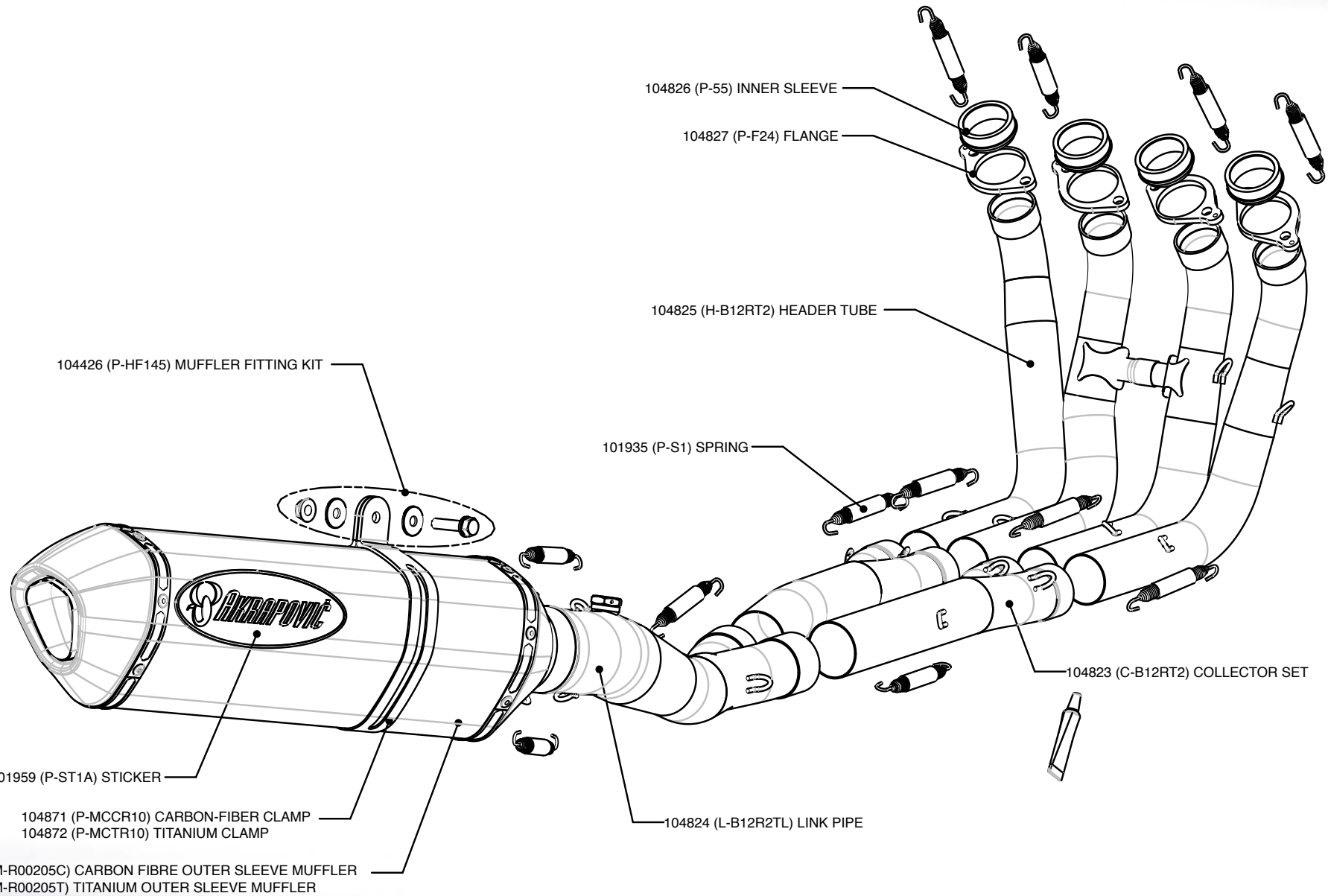

Akrapovic Exhaust System Technology copyright 2006, all rights reserved

Road Program

Product code: 104980 (S-B12RFT2TL-RC), 104981 (S-B12RFT2TL-RT) evolution

Akrapovic Racing & Evolution Exhaust System for the BMW K 1200 S (2005)

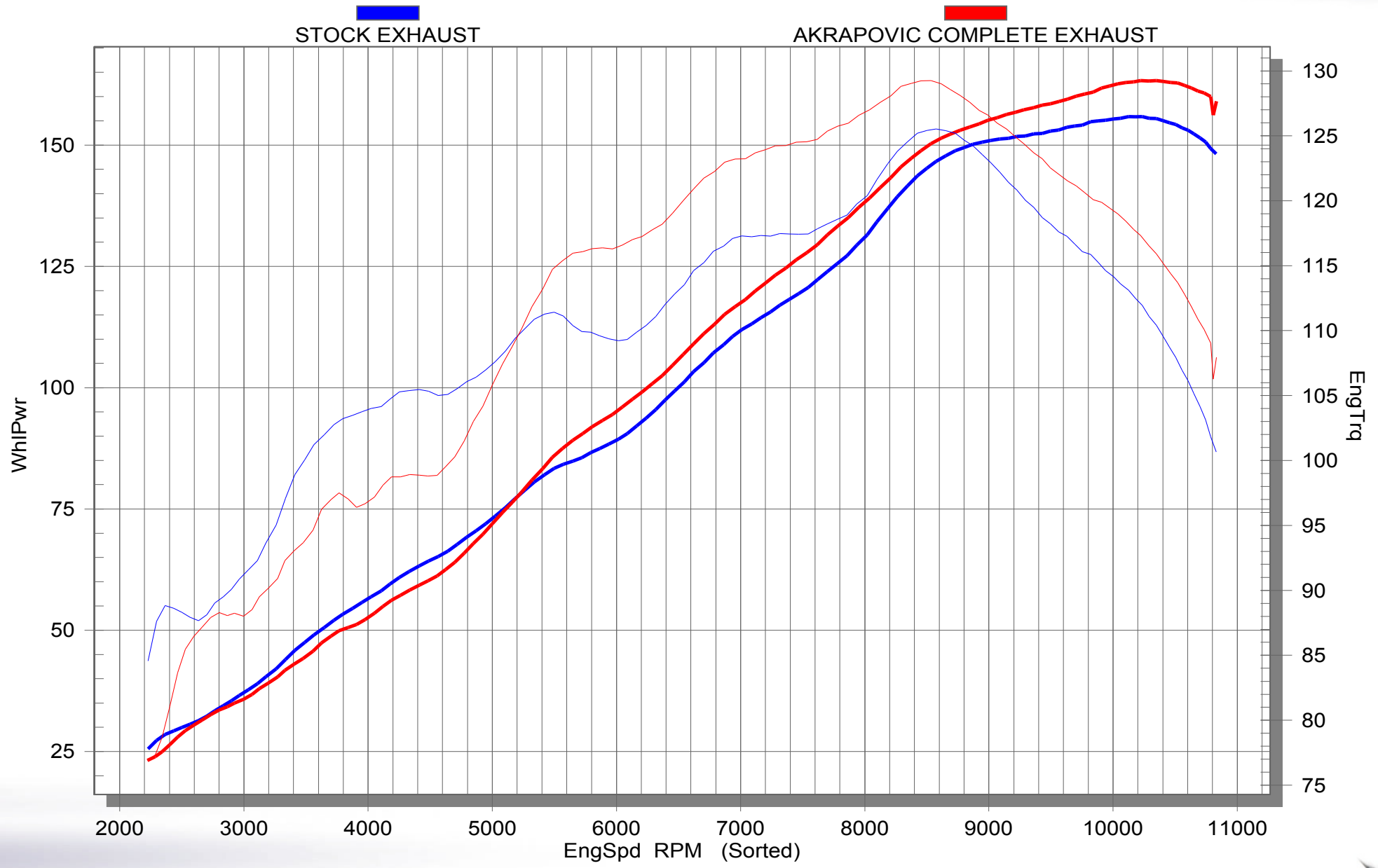

Road Program

Product code: 104978 (S-B12R2-RC), 104979 (S-B12R2-RT) racing
104980 (S-B12RFT2TL-RC), 104981 (S-B12RFT2TL-RT) evolution



Akrapovic Exhaust System Technology copyright 2006, all rights reserved

Akrapovic Racing & Evolution Exhaust System for the BMW K 1200 R (2005)

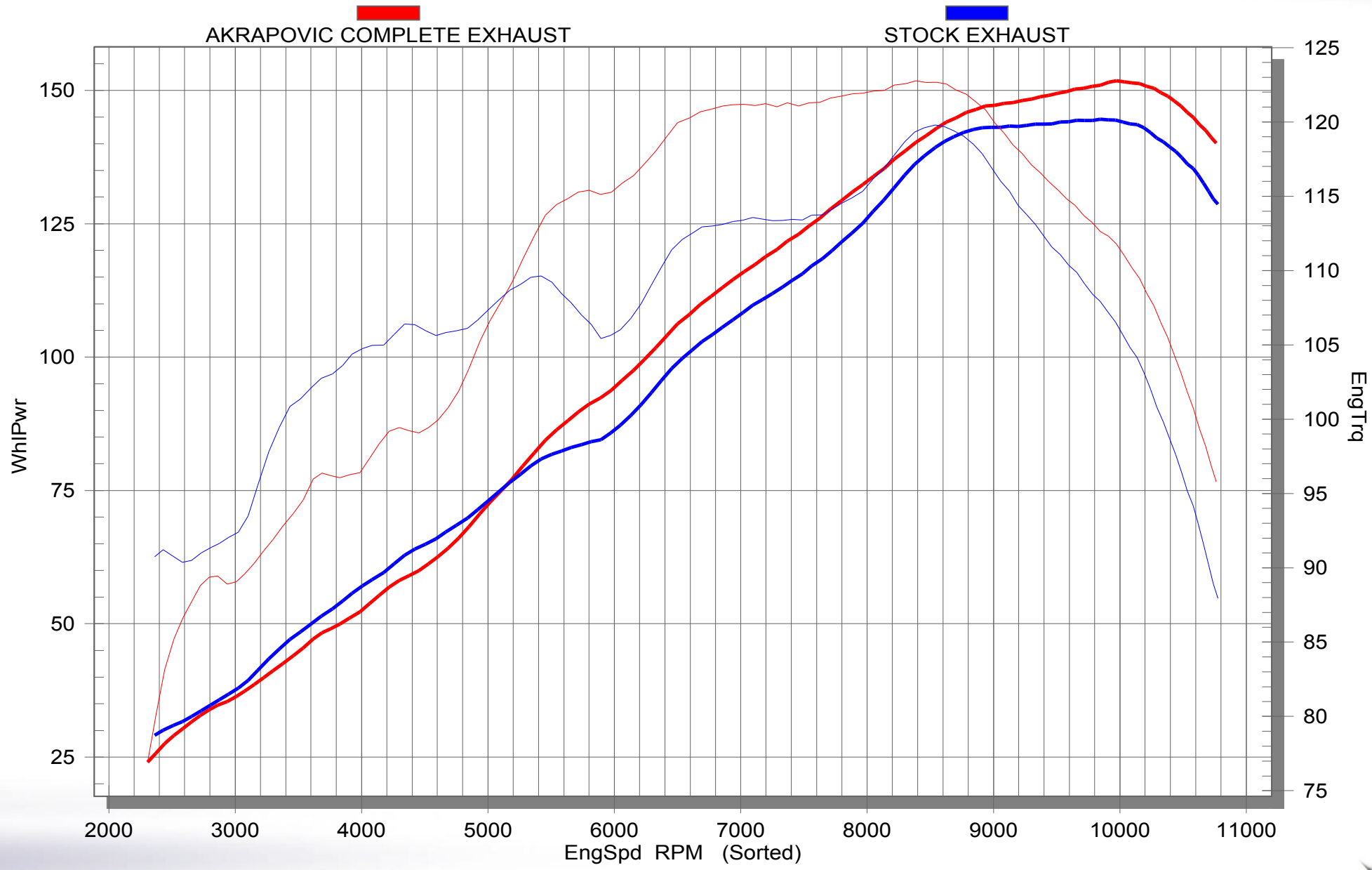

Road Program

Product code: 104978 (S-B12R2-RC), 104979 (S-B12R2-RT) racing
104980 (S-B12RFT2TL-RC), 104981 (S-B12RFT2TL-RT) evolution



Akrapovic Exhaust System Technology copyright 2006, all rights reserved